



SAFETY PROTOCOLS

Battery Charging

- No charging of personal electronics in chalets when unoccupied
- Staff will unplug any devices they find plugged in when servicing your chalet
- Only charge camera equipment at designated charging stations and not in your chalet
- Only charge Lithium-ion batteries at outside charging stations and not inside the chalet
- All charging stations will be unplugged when guests go to bed

Smoke Detectors

All devices are serviced every six months

- Test power source
- Replace batteries (for battery operated units)
- Test smoke sensors using canned smoke or smoke matches

Smoking

- Is only allowed in designated area
- Smoking Area: outside of tented chalets

Chalet Orientations

- A staff member will show you to your chalet and provide an orientation including:
 - Showing the main escape route and explain how to reach the Muster Station
 - Showing where the nearest fire extinguisher is and instructions on how to use it
 - When the Welcome Briefing will be held
- The safety systems presented will be reviewed again in the Welcome Briefing.

Night Safety Watch

- Night Safety Watch is a staff member or on-duty night watchman awake and performing duties while others sleep from 5 PM to 5 AM
- Night Safety Watch Duties Include:
 - Conducting regular rounds throughout the property
 - Ensuring all emergency exits are accessible

Muster Station

- Located at front of property
- If alarm sounds – Do NOT return to your chalet.

Safety Comes First

If something feels wrong,

Don't Wait!

Tell one of the staff immediately.



EVACUATION PLAN

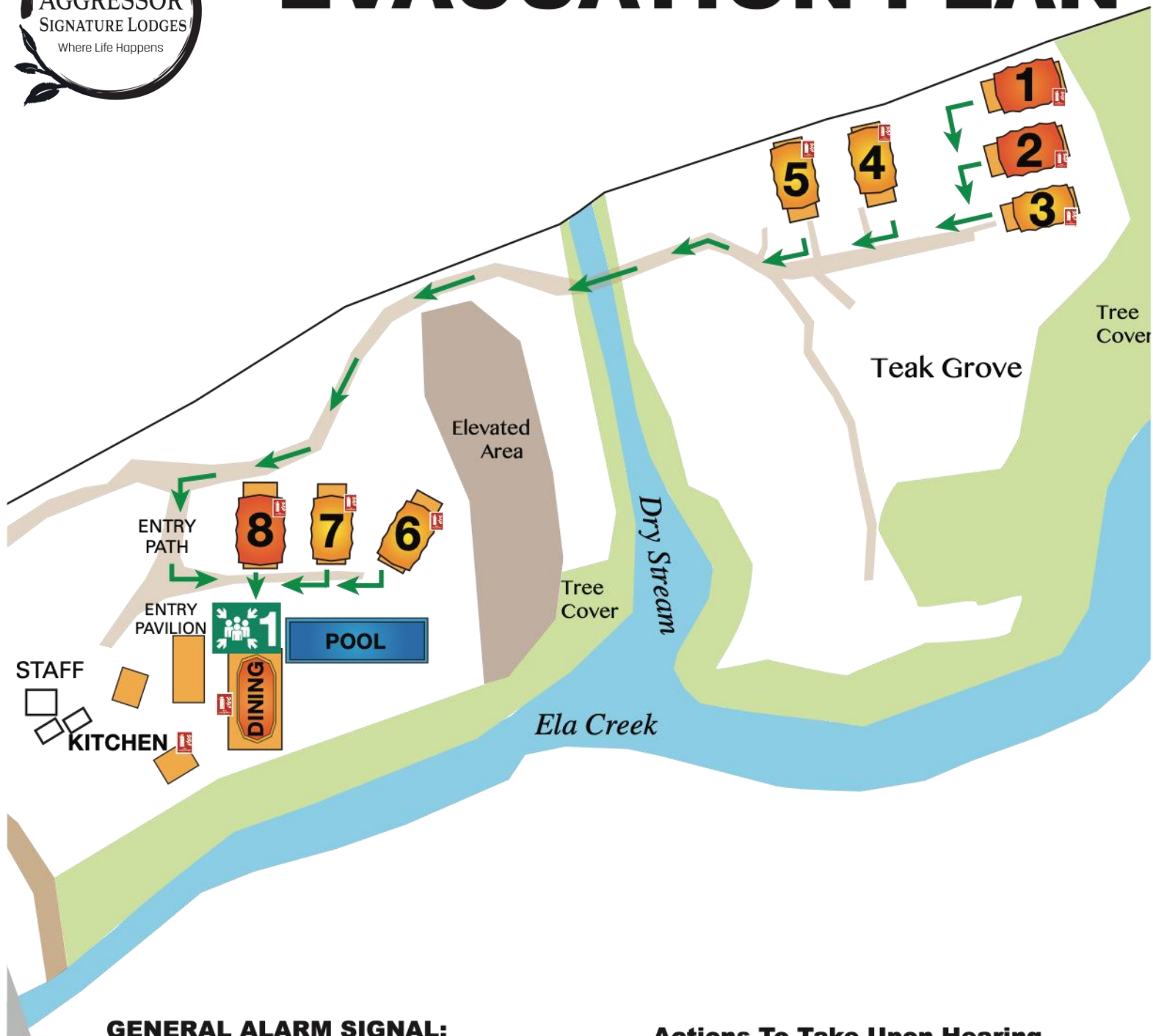

GENERAL ALARM SIGNAL:

In the event of an emergency, the following signal will be sounded on the lodge's horn: Seven short blasts followed by one long blast.

Actions To Take Upon Hearing The General Alarm Signal:

- Proceed directly to Muster Station #1
- Assist those who need help
- Follow the instructions of staff members
- DO NOT return to your stateroom to collect your property



Muster Station



Fire Extinguisher

 **Primary Exit**

 **You Are Here**



SAFETY SUMMARY

Standard Operating Procedures

Safety is our top priority. All Aggressor destinations operate according to their brand's Standard Operating Procedures (SOP) manual. These standards ensure a consistent experience for our guests and written instructions for training of staff, regardless of their location. The SOP also specifies the safety equipment required for the destination and emergency drills. Drills are conducted regularly for staff training. For some drills, we may invite you to participate with us!

Aggressor Safari Lodge Safety Summary:

General Information		Notes
Adventure Briefing	✓	
Safety Briefing	✓	
Welcome Briefing	✓	

EMERGENCY		Notes
Emergency Alarm System	✓	
Fire Drills	✓	

FIRE SAFETY		Notes
Public area fire extinguishers	✓	
Muster Stations	✓	

MEDICAL		Notes
First Aid Kit	✓	
Rescue Station	✓	1 mile from property

CHALETS		Notes
Emergency Exits	✓	
Fire Extinguishers	✓	Small units in bathroom

GENERAL		Notes
Environmental Care / Sustainability	✓	See 
Emergency Exits	✓	
Mobile Phone (cellular)	✓	
Night Watch	✓	5 PM to 5 AM
Satellite Phone		
Smoking Permitted	✓	In designated areas only
Wi-Fi / Internet / Email	✓	Front areas of property
Sustainable land development	✓	Only 30% of land to be developed, balance left natural

STAFF		Notes
Social Responsibility / Care	✓	
First Aid Training	✓	
Firefighting Training	✓	

LODGE		Notes
Electrical System	✓	3 phase
Generators	✓	80 KW backup